



KORODUR Design Floor
original. sustainable. **unique.**



KORODUR Design Floor

KORODUR Design Floor original. sustainable. unique.

The mineral industrial floor as design floor. Based on its core competency in the field of hard aggregate industrial floors KORODUR has developed further new products and systems by the end of the 1990ies, especially in the field of design floors - cementitious-mineral, durable, creative and elegant.

Any KORODUR design floor represents a handcraft work of art and thus indeed is unique. KORODUR design floors form the optimum synthesis of durability, optical appearance, originality, and the request for sustainability.

KCF® KORODUR COPETTI FLOOR



Libeskind Villa, Datteln

GRANIDUR®



Baumann Automation, Amberg

TRU® Self-Leveling



Ferrari-Garage, Hirschau

8 Important Hints

A KORODUR design floor is not a floor out of the box but unique.

You need:

- teamwork between builder owner, architect and specialized installer from planning to completion
- expert knowledge, experience, handcraft skill as well as economic and aesthetic sensitivity
- experienced and qualified installers
- detailed planning (e.g. joints, surface structure)
- knowledge about risks in context with cement screeds*
- inspection of reference jobs
- prior test areas
- first maintenance treatment / stain protection / routine cleaning and care

- mineral
- original
- sustainable
- creative
- unique



Libeskind Villa, Datteln



Subway station, Cologne



Porsche, Lörrach



High School, Marienstatt

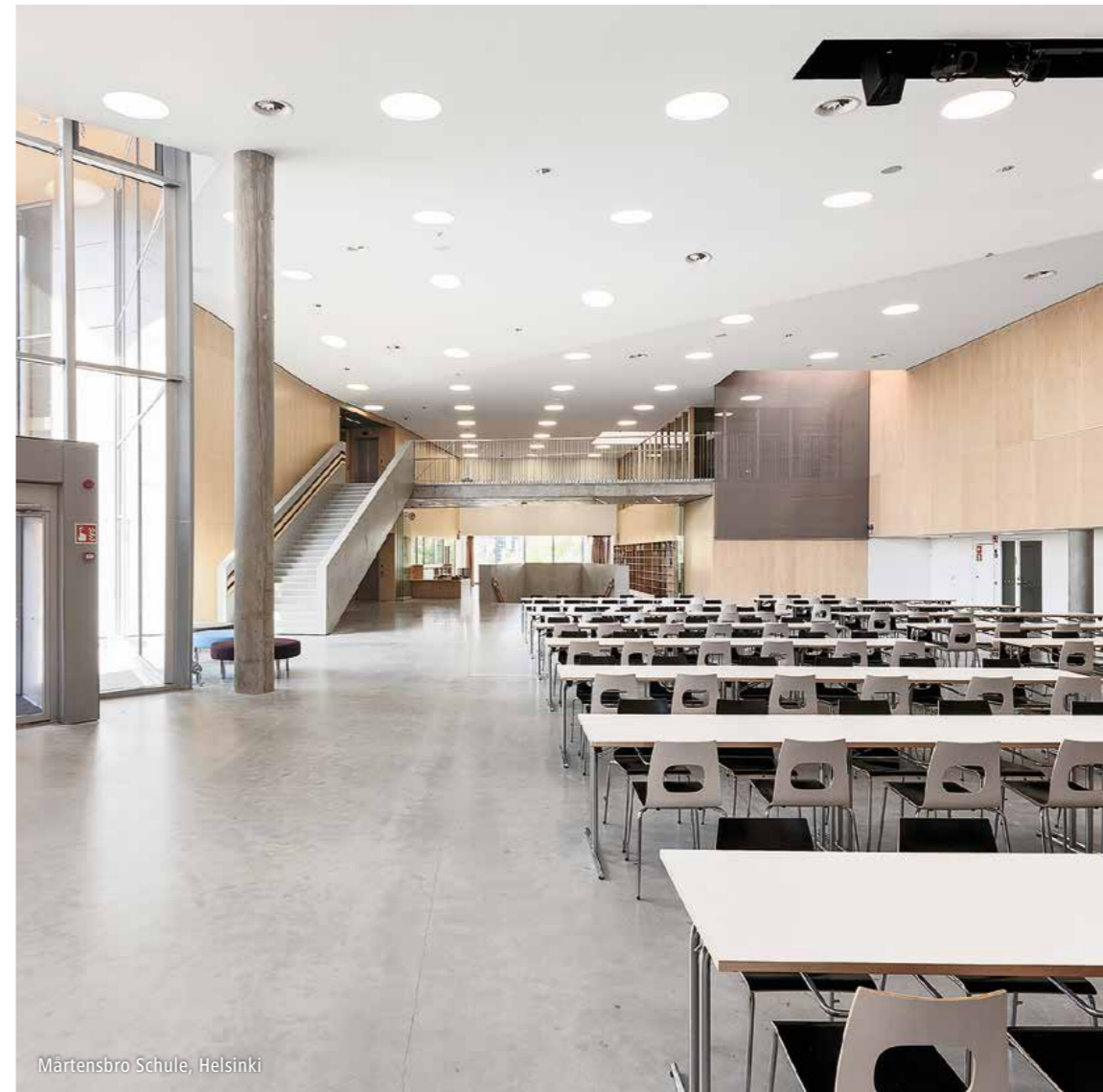

Mårtensbro Schule, Helsinki



Hut Up, Berlin

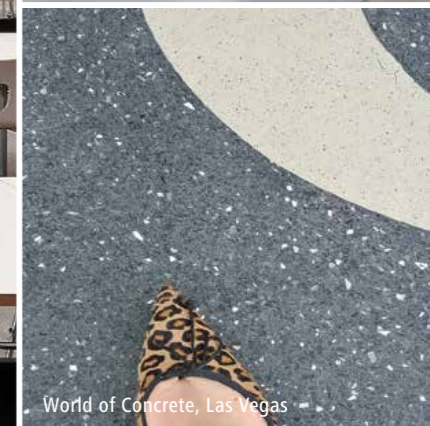

World of Concrete, Las Vegas



Cats Hostel, Berlin



Baumann Automation, Immenstetten



Art of Chocolate, Wertheim Village

KORODUR Design Floor

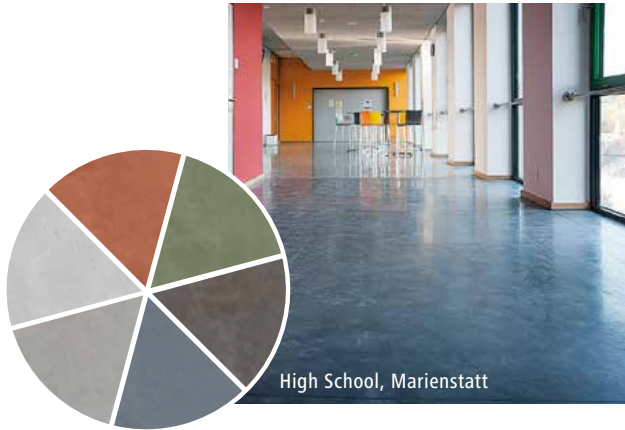

KCF® KORODUR COPETTI FLOOR

The cementitious, smoothed decorative screed of KORODUR - known as KORODUR COPETTI FLOOR, was developed together with the Italian architect and designer Alessandro Copetti in the 1990ies. One of the first impressive KORODUR COPETTI FLOORS (in short KCF) was realized in the Teatro Armani in Milano, planned and designed by the Tokyo architect Tadao Ando. An area of 3.000 m² of KCF floor contributes as optical support for the international Armani collections.



GRANIDUR®

The polished decorative screed of KORODUR is known as GRANIDUR design floor. The final granite resp. terrazzo optic of a GRANIDUR floor can range from matt to glossy, according to the ideas and creativity of the builder owner and planner. In Cologne, since Christmas 2013, passengers walk and wait for trains on a unique, wear-resistant decorative GRANIDUR floor in the fully renovated subway station Heumarkt of the North-South route. The other subway stations of this line will be modernized accordingly in the coming years.

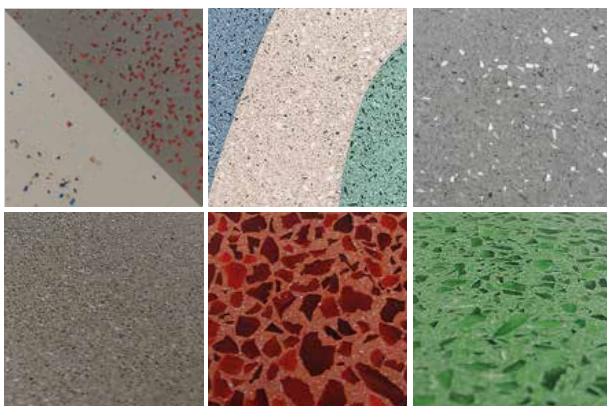

TRU® Self-Leveling

TRU Self-Leveling is a fast-setting, and ideal for polishing decorative floor, for indoors and outdoors, with exceptional features. The unique product features of TRU are based on the high performance and innovative Rapid Set Cement Technology of the US. TRU Self-Leveling can be carried out in various colors. Additional, individual effects can be achieved by sprinkling of decorative aggregates (e.g. glass, marble).

Product Features

PRODUCT TYPE	COLORS	QUALITY	GRAIN SIZE	APPLICATION/LAYER THICKNESS		CONSUMPTION KG / M ² / MM	COMPRESSIVE STRENGTH	FLEXURAL STRENGTH	PRIMER	FIRST MAINTENANCE	ROUTINE CLEANING	SPECIAL FEATURES			
				acc. to DIN 18560-3 on base concrete in one layer in composite	acc. to DIN 18560-4 in one layer on separation layer										
KCF® KORODUR COPETTI FLOOR KORODUR design floor in marble, smoothed optics	KCF 05	cement-grey, light-grey, basalt-grey, anthracite, red, beige, olive	CT - C45 - F6 - A5	0 - 5 mm	15 - 25 mm	not recommended	not recommended	2,1 kg	45,0 N/mm ²	6,0 N/mm ²	KORODUR HB 5	<input checked="" type="checkbox"/>	<input checked="" type="checkbox"/>	<input checked="" type="checkbox"/> smoothed-marbled <input checked="" type="checkbox"/> anti-skid <input checked="" type="checkbox"/> mineral <input checked="" type="checkbox"/> original <input checked="" type="checkbox"/> sustainable <input checked="" type="checkbox"/> unique	
	KCF 08	CT - C35 - F5 - A5	0 - 8 mm	25 - 50 mm	45 - 70 mm	45 - 70 mm	35,0 N/mm ²		5,0 N/mm ²	<input checked="" type="checkbox"/>		<input checked="" type="checkbox"/>			
GRANIDUR® polished KORODUR design floor in granite optics	GRANIDUR 03	cement-grey, light-grey, basalt-grey, anthracite, red, beige, olive	CT - C45 - F6	0 - 3 mm	in middle 15 mm	not recommended	not recommended	2,1 kg	45,0 N/mm ²	6,0 N/mm ²	KORODUR HB 5	<input checked="" type="checkbox"/>	<input checked="" type="checkbox"/>	<input checked="" type="checkbox"/> terrazzo-polished <input checked="" type="checkbox"/> anti-skid <input checked="" type="checkbox"/> mineral <input checked="" type="checkbox"/> original <input checked="" type="checkbox"/> sustainable <input checked="" type="checkbox"/> unique	
	GRANIDUR 05		CT - C45 - F6	0 - 5 mm	15 - 25 mm	not recommended	not recommended		45,0 N/mm ²	6,0 N/mm ²		<input checked="" type="checkbox"/>	<input checked="" type="checkbox"/>		
	GRANIDUR 08	CT - C35 - F5	0 - 8 mm	25 - 50 mm	45 - 70 mm	45 - 70 mm	35,0 N/mm ²		5,0 N/mm ²	<input checked="" type="checkbox"/>		<input checked="" type="checkbox"/>			
	GRANIDUR BIANCO	„white“ with mostly light aggregates	CT - C45 - F6	0 - 5 mm	in middle 15 mm	not recommended	not recommended		45,0 N/mm ²	6,0 N/mm ²		KORODUR HB 5 white	<input checked="" type="checkbox"/>		<input checked="" type="checkbox"/>
	GRANIDUR NERO	anthracite with mostly dark aggregates	CT - C45 - F6	0 - 5 mm	in middle 15 mm	not recommended	not recommended		45,0 N/mm ²	6,0 N/mm ²		KORODUR HB 5	<input checked="" type="checkbox"/>		<input checked="" type="checkbox"/>
TRU® Self-Leveling self-leveling, fast-setting design floor	TRU Self-Leveling	individual coloring, decorative aggregates	CT - C40 - F10	0 - 1 mm	4 - 35 mm	not recommended	not recommended	1,7 kg	after 4 h 20,0 N/mm ² after 24 h 34,0 N/mm ² after 28 d 45,0 N/mm ²	after 24 h 6,0 N/mm ² after 28 d 11,0 N/mm ²	KORODUR TXPK	<input checked="" type="checkbox"/>	<input checked="" type="checkbox"/>	<input checked="" type="checkbox"/> self-leveling <input checked="" type="checkbox"/> terrazzo-polished <input checked="" type="checkbox"/> fast-setting <input checked="" type="checkbox"/> multipurpose <input checked="" type="checkbox"/> individual <input checked="" type="checkbox"/> attractive	

Fields of application: sales rooms, museums, show rooms, boutiques, foyers, office and administration buildings, restaurants, galleries, and any other representative locations.

Basically, the current technical data sheet refers.



Polipol Polstermöbel, Diepenau

Construction Examples

Depending on the design requirement and the usage, we offer you different products with different construction systems to suit your needs. Following four construction examples.



Composite screed acc. to DIN 18560-3

KCF 05, GRANIDUR 03/05/Bianco/Nero

- first maintenance
- design floor
- bonding compound
- supporting sub-base



Screed on separation layer acc. to DIN 18560-4

KCF 08, GRANIDUR 08

- first maintenance
- design floor
- separation layer
- supporting sub-base

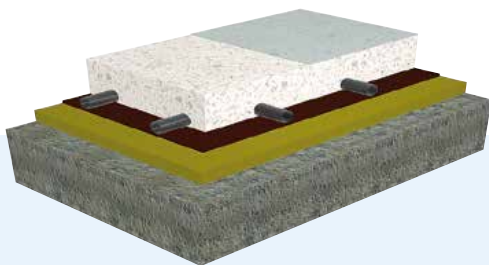

Heating screed on insulation layer acc. to DIN 18560-2

KCF 08, GRANIDUR 08

- first maintenance
- design floor
- cover layer
- insulation layer
- supporting sub-base



Thin screed in composite

TRU Self-Leveling

- first maintenance
- design floor
- primer
- supporting sub-base



KORODUR International GmbH
Werner-von-Braun-Str. 4
92224 Amberg, Germany
Phone: +49 (0) 96 21 / 47 59 – 0
Telefax: +49 (0) 96 21 / 3 23 41
info@korodur.de
www.korodur.com

* KORODUR design floors are cement screeds and are subject to building physics laws. Unfavorable site conditions and unpredictable influences - such as temperature, air draught or sun radiation - can cause unforeseen aspects (cracks / bowling). In particular, cracks can have most different causes and cannot be totally excluded. Depending on the quality of planning and execution their number and extent can be considerably reduced. Cracks contribute to the authenticity of the floor and are not considered as depreciation of the creative performance. KORODUR design floors are based on natural raw materials. Color and texture variations cannot be excluded. Depending on the time of day, the incidence of light or the position of the observer, the floor surfaces may have differing optical appearances.

0814/450



Hilti Headquarters, Liechtenstein



Teatro Armani, Milano

